

TOTAL APPROX. FLOOR AREA 418 SQ.FT. (38.8 SQ.M.)

Whilst every attempt has been made to ensure the accuracy of the floor plan contained here, measurements of doors, windows, rooms and any other items are approximate and no responsibility is taken for any error, omission, or mis-statement. This plan is for illustrative purposes only and should be used as such by any prospective purchaser. The services, systems and appliances shown have not been tested and no guarantee as to their operability or efficiency can be given

Made with Metropix ©2019

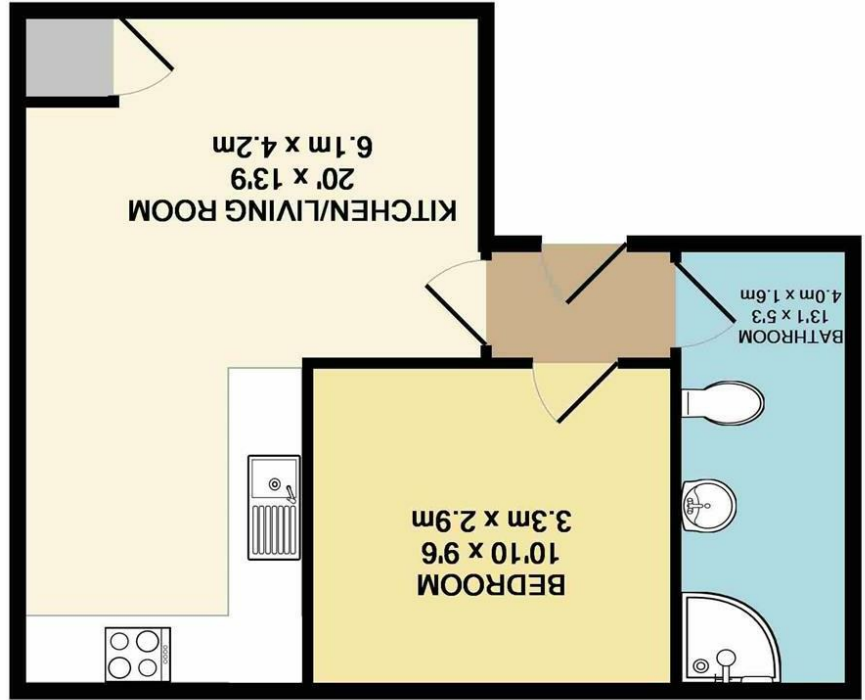

Disclaimer - In accordance with the Property Misdescriptions Act, the company gives notice that all descriptions, references to condition, necessary permissions for use and other details are given in good faith and believed to be correct, but any intending lessees do not rely on them as statements of fact, but must satisfy themselves by inspection or other means, as to their accuracy.

| Energy Efficiency Rating |         |
|--------------------------|---------|
| Potential                | Current |
| 53                       | 53      |

| England & Wales                             |             |
|---|-------------|
| EU Directive 2002/91/EC                     |             |
| Very energy efficient - lower running costs | (92 plus) A |
|   | (81-91) B   |
|   | (69-80) C   |
|   | (55-68) D   |
|   | (39-54) E   |
|   | (21-38) F   |
| Not energy efficient - higher running costs | (1-20) G    |



**Norfolk Property online.**

Surrey Street | Norwich | NR1  
**Guide price £160,000**

Norfolk Property Online presents this stylish modern apartment. Located within the popular Sentinel House development, which includes excellent on-site facilities such as a concierge service, residents lounge and gym, this spacious apartment offers an ideal investment opportunity or first time buy. With accommodation comprising of open plan living accommodation, double bedroom and stylish shower room, an internal viewing comes highly recommended.

Guide Price - £160,000 - £170,000

